

Foilmec™ is optimised for use with foil overlays and offers a fully illuminated solution based on up to 4 LEDs placed directly on the PCB.

The illumination can be either SMT or through-hole and provides a free choice of light source.

Foilmec™ is the ideal solution to cost-effective assembly of highly integrated PCB with keys, whether SMT or TH.

The basic switch for Foilmec™ is rugged and reliable with a mechanical life exceeding 10,000,000 cycles. The switch is sealed to IP67

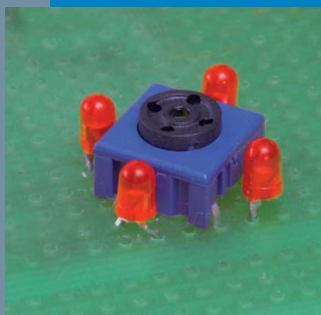
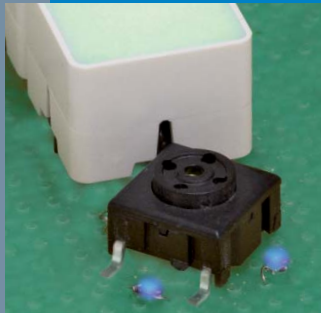

Distribuidor:

**ERMEC**  
www.ermec.com  
Distribución de componentes  
eléctricos y electrónicos

Tel.: (+34) 902 450 160  
Fax: (+34) 902 433 088  
[ermec@ermec.com](mailto:ermec@ermec.com)  
[www.ermec.com](http://www.ermec.com)

## Technical Data:

- through-hole or SMD
- 50mA/24VDC
- single pole/momentary
- 10.000.000 operations life time
- IP67 sealing
- temperature range:  
std. temp: -40/+115°C  
high temp: -40/+160°C  
keycap: -30/+85°C



### Dimensions (through-hole)

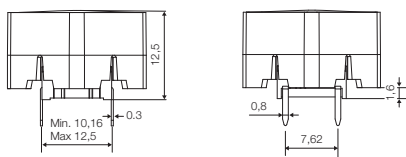

### PCB layout

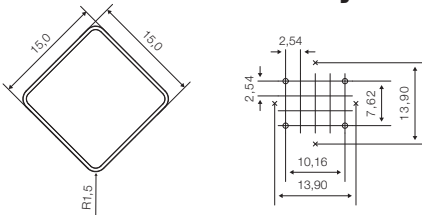

### Dimensions (SMD)

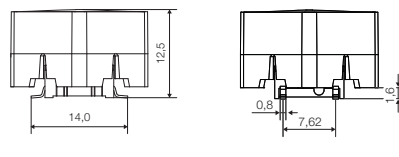

### PCB layout

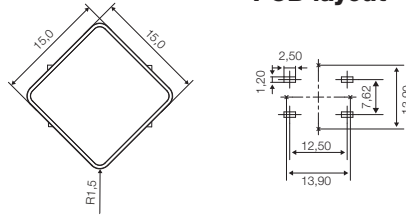

### Recommended placement of LEDs

(TH Ø3mm)

(SMD)

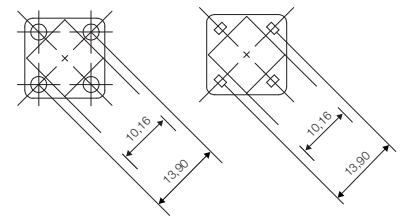

### LED Recommendation

SMD: 1206 - 0805 - 0603 - 0402

TH: 3 mm - Ø max. 3,2 - Height Max. 6,5 mm

Wide spread angle versions recommended

### How to order

**3 E**

**Switch**

**□**

**Mounting**

**T** through-hole

**S** surface mount

**□ □**

**L 6** low temp.  
**H 9** high temp.

**+**

**1 Y 0 6 1 6**

**Cap white**

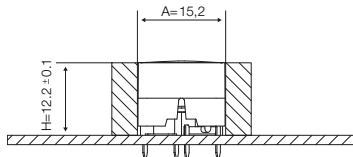
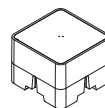

A: We recommend you to allocate enough space for travel of the foil and leave the area free from adhesive. Switch travel = 1 mm.

H: We recommend embossing the foil to follow the curve of the keycap.

The best tactile feeling is obtained by a small pretravel of typically 0.2 mm.

The dimension H is based on a flat foil. With an embossed foil the dimension will have to be adjusted.

Dimensions (mm) Unless otherwise specified, all tolerances ± 0,2

**Ordering example:** 3ESH9 +1Y0616

For updates of products and/or changes of specifications please see [www.mec.dk](http://www.mec.dk)

**ERMEC**  
www.ermec.com  
Distribución de componentes  
eléctricos y electrónicos

**ERMEC, S.L. BARCELONA**  
C/ Francesc Teixidó, 22  
E-08918 Badalona  
(Spain)

**Tel.: (+34) 902 450 160**  
**Fax: (+34) 902 433 088**  
[info@ermec.com](mailto:info@ermec.com)  
[www.ermec.com](http://www.ermec.com)

**ERMEC, S.L. MADRID**  
C/ Sagasta, 8, 1ª planta  
E-28004 Madrid  
(Spain)

**PORTUGAL**  
[portugal@ermec.com](mailto:portugal@ermec.com)  
**BILBAO**  
[bilbao@ermec.com](mailto:bilbao@ermec.com)