

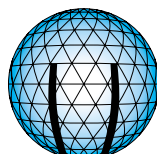

PLK & PLR SERIES **Professional keylock or rotary switches**

NEW RANGE

- Miniature & subminiature
- 2 to 12 positions
- 1 to 4 poles



A P E M

ERMEC
www.ermec.com
Distribución de componentes
eléctricos y electrónicos

Tel.: (+34) 902 450 160
Fax: (+34) 902 433 088
ermec@ermec.com
www.ermec.com

PLK - PLR SERIES

PROFESSIONAL KEYLOCK OR ROTARY SWITCHES

Distinctive features

PLK SERIES - KEYLOCK SWITCHES

- Tapered lock face
- 2 or 3 positions
- Single or double pole
- Indexing : 90° (single pole) or 60° (double pole)
- Up to 200 different keys
- Double entry keys (can be inserted into the lock either way up)
- 5 disc lock type
- Miniature size, occupy small panel area
- Rear projection less than 30 mm from panel
- Easily assembled through front of panel
- Option : sealed terminals
- *Models with straight lock face available on request*



PLR SERIES - MINIATURE ROTARY SWITCHES

- 2 to 12 positions
- 1 to 4 poles
- Indexing : 30° on standard models, 60° or 90° optional
- Models with continuous rotation
- Adjustable stop to restrict number of position
- Shorting (make before break) or non shorting (break before make) contacts
- Solder lugs or PCB pins
- Options available :
 - no bush version
 - rear drive version
 - sealed terminations



PLRT SERIES - SUBMINIATURE ROTARY SWITCHES

- Standard TO-5 housing
- 2 to 8 positions
- Single or double pole
- 45° indexing
- Continuous rotation available on 8-position models
- Actuator : spindle
- Option : protective cover
- *Models with screwdriver slot available on request*

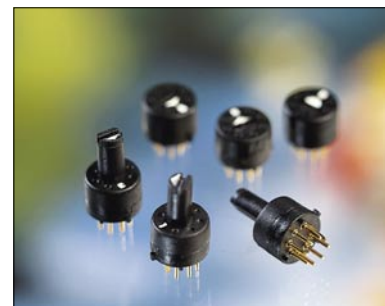

Dimensions : First dimensions are in mm while inches are shown as bracketted numbers.

Tolerance : The general tolerance for dimensions in this brochure is +/- 0,3 (.012).

Dimensions, specifications and data shown in this brochure are subject to change without notice.

PLK SERIES

PROFESSIONAL KEYLOCK SWITCHES

Tapered lock face

GENERAL SPECIFICATIONS

- Max. current/voltage rating (resistive) : 0,5A 30VDC
- Life : 10.000 cycles
- Initial contact resistance : 20 mΩ max.
- Insulation resistance : 100 MΩ min.
- Dielectric strength : 750 Vrms.
- Operating temperature : -20°C to +65°C
- Lock type : 5 disc
- Standard hardware supplied : 1 hex nut

MATERIALS

- Case : polyester, glass filled
- Bushing : zinc alloy, chrome plated
- Contacts : brass, silver plated

PANEL CUT-OUT

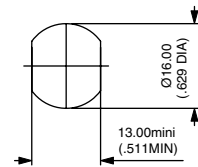

| Movement | Number of positions | Number of poles | Key withdrawal position | Indexing | Number of keys | Key sets | MODEL NO | Switching diagram |
|----------|---------------------|-----------------|-------------------------|----------|----------------|---------------|-----------------|-------------------|
| 90° | 2 | 1 | 1-4 | 90° | 2 | same | PLKB3220 | |
| 90° | 2 | 1 | 1-4 | 90° | 2 | 200 different | PLKB3221 | |
| 90° | 2 | 1 | 1 | 90° | 2 | same | PLKB3120 | |
| 60° | 2 | 2 | 1-3 | 60° | 2 | same | PLKB4220 | |
| 60° | 2 | 2 | 1 | 60° | 2 | same | PLKB4120 | |
| 180° | 3 | 1 | 1-4-7 | 90° | 2 | 200 different | PLKB8321 | |

Dimensions

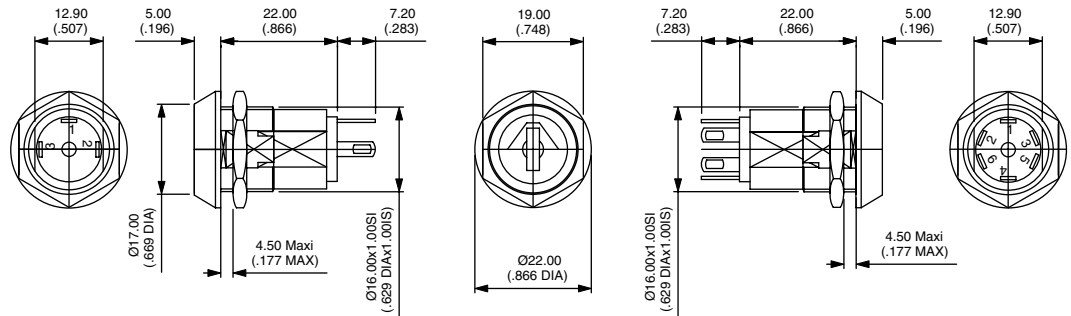

PLR SERIES

PROFESSIONAL MINIATURE ROTARY SWITCHES

GENERAL SPECIFICATIONS

- Max. voltage (resistive) : 250V AC/DC
- Max. current : 150mA
- Initial contact resistance : 20 mΩ max.
- Insulation resistance: 1.000 MΩ min.
- Dielectric strength : 1.000 Vrms
- Life : 10.000 cycles
- Operating torque : 8,6 Ncm ±2
- End stop torque : 1,13 Ncm min.
- Fixing torque : 1,1 Ncm max.
- Operating temperature : -30°C to +85°C
- Standard hardware supplied : 1 hex nut and 1 locking ring
- Special accessories (buttons) : see page 7

MATERIALS

- Moulded parts : PA 6/6, glass filled
- Contacts : brass, gold or silver plated, depending on version

PANEL CUT-OUT

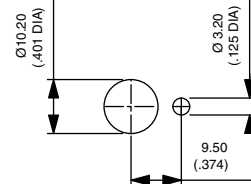

Dimensions

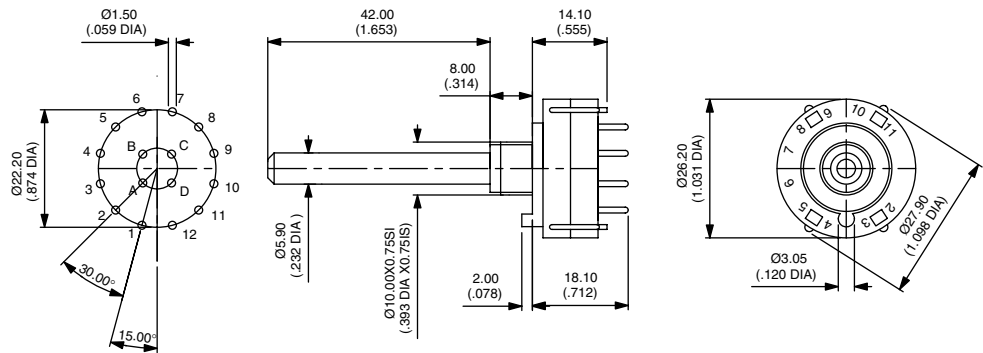

Available configurations (top view)

30° INDEXING (standard)
(models listed opposite)

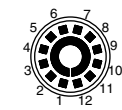

1 pole, 12 pos.

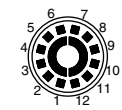

2 poles, 6 pos.

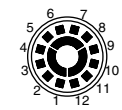

3 poles, 4 pos.

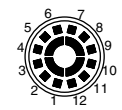

4 poles, 3 pos.

60° INDEXING
(on request)

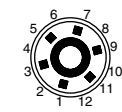

1 pole, 6 pos.

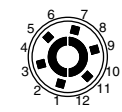

2 poles, 3 pos.

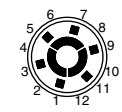

3 poles, 2 pos.

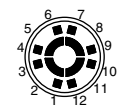

4 poles, 2 pos.

90° INDEXING
(on request)

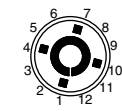

1 pole, 4 pos.

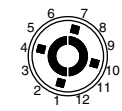

2 poles, 2 pos.

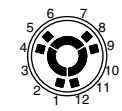

3 poles, 2 pos.

PLR SERIES

PROFESSIONAL MINIATURE ROTARY SWITCHES

Models with 30° indexing

- Metric type
- Spindle diameter : 6 mm

- Spindle length : 42 mm
- Bushing : L 8 mm, M10 x 0,75

Preferred

| DESCRIPTION | Contact material | Shorting | Non-shorting |
|--|------------------|----------|--------------|
| 1 pole, 12 positions | | | |
| Solder lugs | Silver plated | PLR3259 | PLR3249 |
| | Gold plated | PLR3728 | PLR3723 |
| PCB pins | Silver plated | PLR3279 | PLR3269 |
| | Gold plated | PLR3732 | PLR3726 |
| 1 pole, 12 positions, continuous rotation | | | |
| Solder lugs | Silver plated | PLR3258 | PLR3248 |
| | Gold plated | PLR3753 | PLR3757 |
| PCB pins | Silver plated | PLR3278 | PLR3268 |
| | Gold plated | PLR3754 | PLR3758 |
| 2 poles, 6 positions | | | |
| Solder lugs | Silver plated | PLR3260 | PLR3250 |
| | Gold plated | PLR3729 | PLR3716 |
| PCB pins | Silver plated | PLR3280 | PLR3270 |
| | Gold plated | PLR3733 | PLR3693 |
| 2 poles, 6 positions, continuous rotation | | | |
| Solder lugs | Silver plated | PLR3334 | PLR3338 |
| | Gold plated | PLR3755 | PLR3759 |
| PCB pins | Silver plated | PLR3339 | PLR3333 |
| | Gold plated | PLR3756 | PLR3760 |
| 3 poles, 4 positions | | | |
| Solder lugs | Silver plated | PLR3261 | PLR3251 |
| | Gold plated | PLR3730 | PLR3734 |
| PCB pins | Silver plated | PLR3281 | PLR3271 |
| | Gold plated | PLR3734 | PLR3720 |
| 4 poles, 3 positions | | | |
| Solder lugs | Silver plated | PLR3262 | PLR3252 |
| | Gold plated | PLR3731 | PLR3725 |
| PCB pins | Silver plated | PLR3282 | PLR3272 |
| | Gold plated | PLR3735 | PLR3727 |

PLRT SERIES

PROFESSIONAL SUBMINIATURE ROTARY SWITCHES

Spindle models

GENERAL SPECIFICATIONS

- Max. current/voltage rating (resistive) : 0,5A 24VAC - 0,2A 48VAC - 0,3A 30VDC
- Contact resistance :
 - initial : 50 mΩ max.
 - after 10.000 cycles : 100mΩ max
- Insulation resistance : 1.000 MΩ min at 500VDC
- Dielectric strength : 1.000 Vrms
- Life : 10.000 cycles
- Operating torque : 1,4 to 2,8 Ncm
- Operating temperature : -30°C to +65°C
- Accessory (protective cover) : see page 7.

MATERIALS

- Case : polyester, glass filled
- Contacts : brass, gold plated
- Terminals : copper alloy, gold plated

DIAGRAM

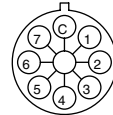

Model numbers and dimensions



| Movement | Number of positions | MODEL NO |
|----------|----------------------|----------|
| 360° | 8 Continuous rot. | PLRT842 |
| 90° | 3 | PLRT331 |
| 135° | 4 | PLRT431 |
| 180° | 5 | PLRT531 |
| 315° | 8 | PLRT833 |

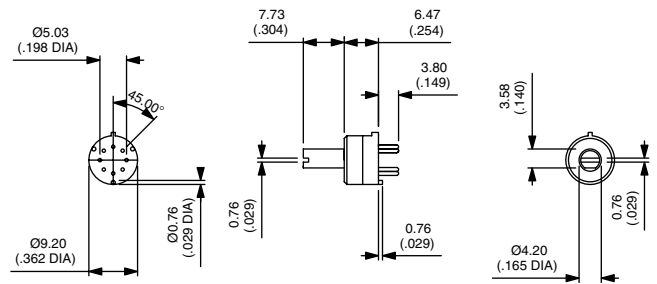

ACCESSORIES

For PLR and PLRT series

Straight knurl knob for PLR series

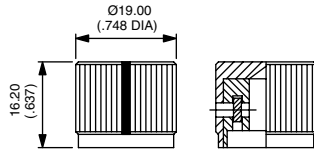

Natural anodized aluminium
U6107

Black anodized aluminium
U6106

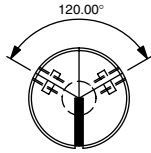

Ribbed knob for PLR series

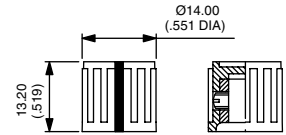

Black plastic
U6108



Protective cover for PLRT series

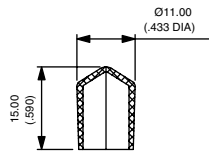

U6105

The APEM subminiature range



Z series



T series

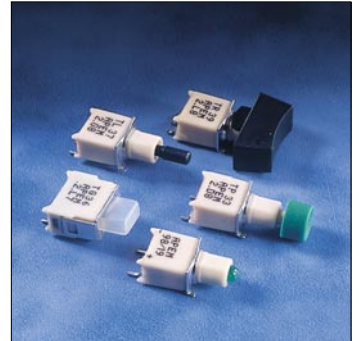

SMT T series

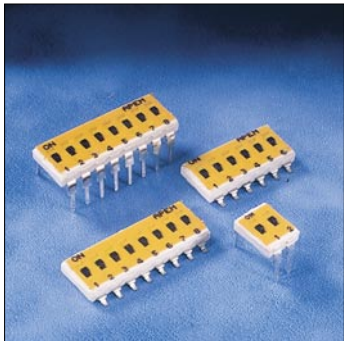

IK series

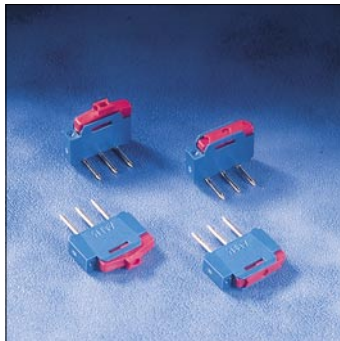

NK series



PHAP series



CR65 series



9000 series

Corporate sales

APEM

Centre d'Affaires Paris Nord - BP 200
 Tour "Le Continental"
 93153 Le Blanc Mesnil Cedex - France
 Tel.: (+33) 1 48 14 92 65 - Fax: (+33) 1 48 14 92 84
 e-mail : apem.com@wanadoo.fr

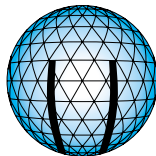

A P E M

Customer Service and Registered Office

APEM

55, avenue Edouard Herriot - BP 1
 82303 Caussade Cedex - France
 Tel.: (+33) 5 63 93 14 98 - Fax: (+33) 5 63 93 19 03
 e-mail : commercial@apem.fr

 Del. n° 34 800 274 50 160
 www.ermec.com
 Distribución de componentes eléctricos y electrónicos
 Fax: (+34) 902 433 088
ermec@ermec.com
www.ermec.com

PLKPLR0209-A