



- High Current Switching - 6600VA max.
- Good inrush current resistance
- Flat insert connectors - faston 6.35 x 0.8 mm
- Applications include heaters and motor control
- Wide range AC coil for 100 to 120VAC 50Hz or 60Hz
- Screw and PCB terminals also available
- Meets RoHS standards

Contact number & arrangement		SPST-NO (1 NO), DPST-NO (2NO)
Contact material		AgCdO
Max. switching voltage		250V AC
Min. switching voltage		5VDC
Rated Load	AC1	20A/220VAC (PCB types), 25A/220VAC (DPST-NO), 30A/220VAC (SPST-NO) Resistive: $\cos\phi = 1$ , Inductive: $\cos\phi = 0.4$
Min. switching current		100mA
Max. inrush current		30A
Rated current		20A (PCB types), 25A (DPST-NO), 30A (SPST-NO)
Max. breaking capacity	AC1	4400 VA (PCB types), 5500 VA (DPST-NO), 6600 VA (SPST-NO)
Resistance		< 50m $\Omega$
Max. operating frequency at rated load	AC1	1800 cycles / hour

### Coil

Rated voltage	AC	6, 12, 24, 50, 100/120, 200/240V
	DC	6, 12, 24, 48, 100
Must release voltage		$\geq 0.15U_n$
Operating range of supply voltage		See Tables 1 & 2

### Insulation

Insulation resistance		1000m $\Omega$ min (at 500VDC)
Impulse withstand voltage		Between coil & contact: 10,000V
Dielectric strength	coil - contact	4000V AC min. / 5000VAC typical, 50/60Hz for 1 minute
	contacts of the same pole	2000V AC min. 50/60Hz for 1 minute
	contacts of different poles (DPST-NO)	2000V AC min. 50/60Hz for 1 minute

### General data

Operating time		30msec max.
Release time		30msec max.
Electrical Life	resistive AC1	$> 10^5$ at 1,800 ops/hour at rated load
	Mechanical life	$> 5 \times 10^6$ at 1,800 ops/hour
Dimensions (L x W x H)		see drawings
Weight		approx. 90g (3.17 oz) quick-connect (fast-on) type
		approx. 100g (3.52 oz) PCB Terminal type
		approx. 120g (4.23 oz) Screw Terminal type
Ambient Temperature		-20... + 85°C (-4...to 185°F)
Humidity		35% to 85% RH
Shock resistance		approx. 100G mechanical durability approx. 10G malfunction durability
Vibration resistance		10 to 55Hz, 1.50mm (0.06") double amplitude

Coil data - DC voltage version

Table 1

Coil code	Rated voltage V DC	Coil resistance ± 15% at 23°C Ω	Coil operating range at 23°C V DC	
			min.	max.
1006	6	18.90	4.5	6.6
1012	12	75	9.0	13.2
1024	24	303	18.0	26.4
1048	48	1220	36.0	52.8
1000	100	5260	75.0	110.0

Coil data - AC 50/60Hz voltage version

Table 2

Coil code	Rated voltage V AC	Coil resistance -20%/+15% at 23°C Ω	Coil operating range at 23°C V AC	
			min.	max.
5006	6	18.90	4.5	6.6
5012	12	75	9.0	13.2
5024	24	303	18.0	26.4
5048	48	1310	36.0	52.8
5110	100/120	5260	75.0	132.0
5230	200/240	21000	150.0	264.0

AC Coil Internal Circuit

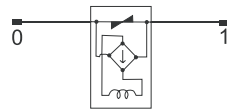

Maximum Switching capacity

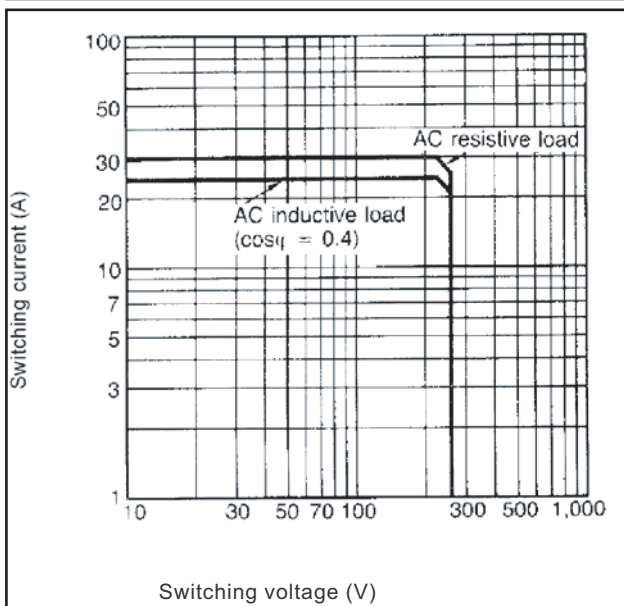

Electrical Service life

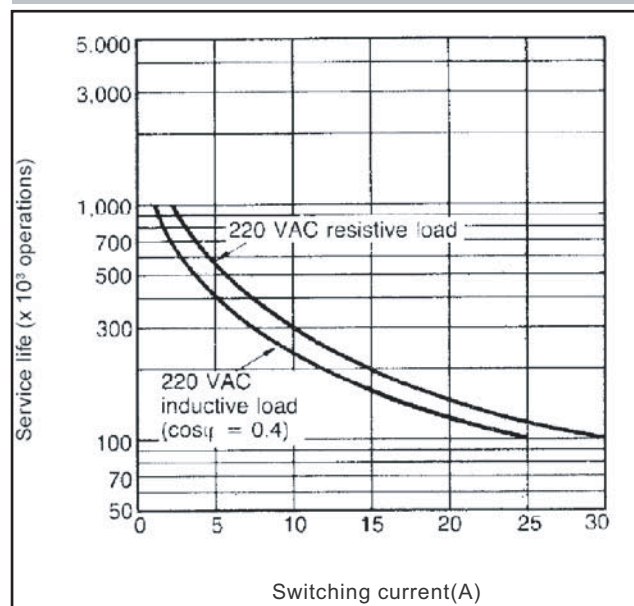

**Ordering Codes**

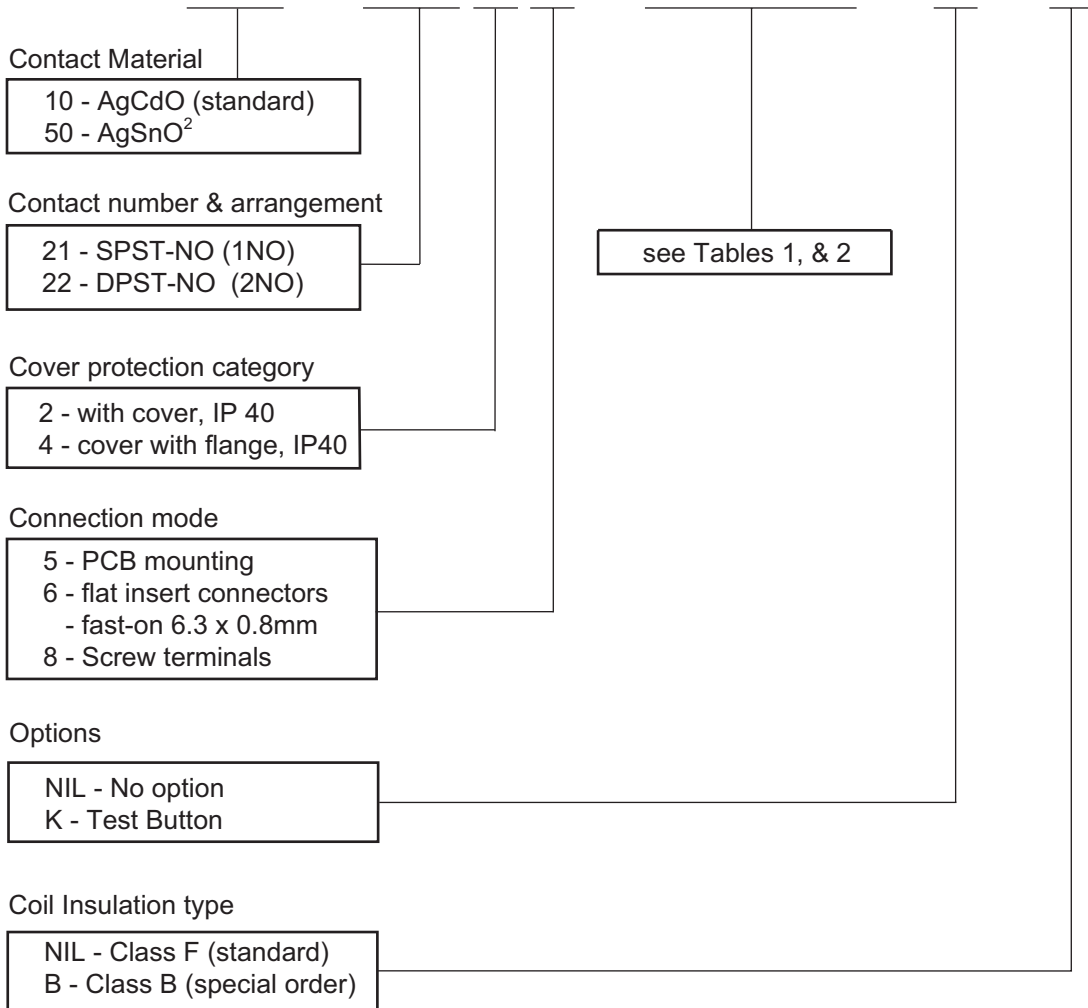
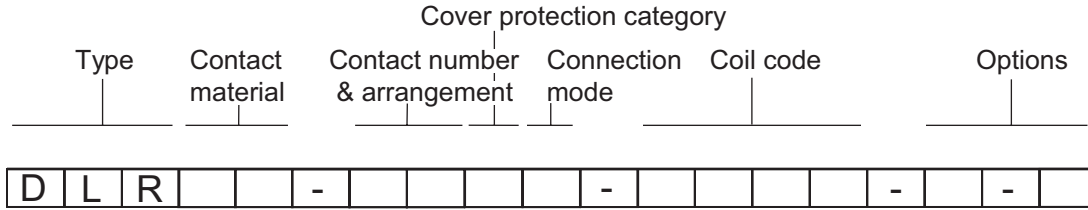

**Dimensions**

unit: mm (inch)

DLR10-2126; DLR10-2126-\*\*\*\*-K  
(E Bracket Attached)\*

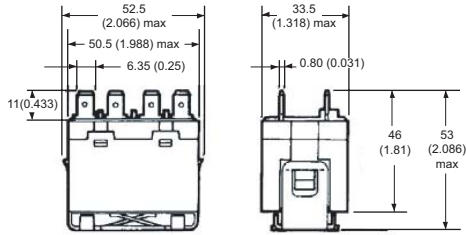

Terminal arrangement/  
Internal connections  
(Top view)



E Bracket  
Mounting holes  
(bottom view)

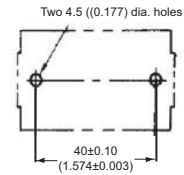

DLR10-2226; DLR10-2226-\*\*\*\*-K  
(E Bracket Attached)\*

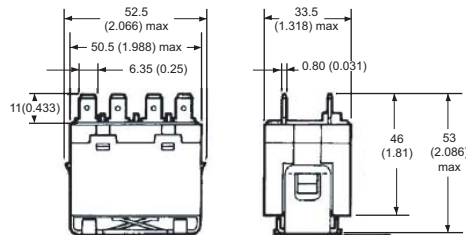

Terminal arrangement/  
Internal connections  
(Top view)

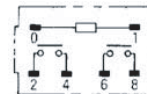

E Bracket  
Mounting holes  
(bottom view)

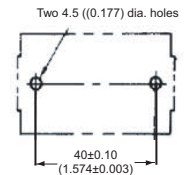

\* E Bracket must be ordered separately - see page 6 for details

DLR10-2146; DLR10-2146-\*\*\*\*-K

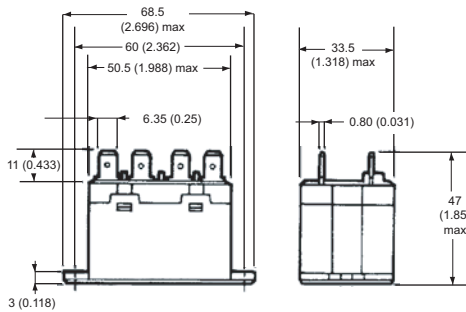

Terminal arrangement/  
Internal connections  
(Top view)

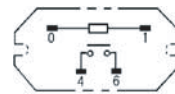

Mounting holes  
(Bottom view)

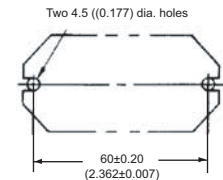

DLR10-2246; DLR10-2246-\*\*\*\*-K

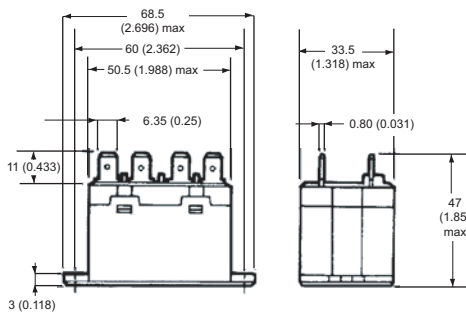

Terminal arrangement/  
Internal connections  
(Top view)

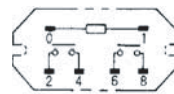

Mounting holes  
(Bottom view)

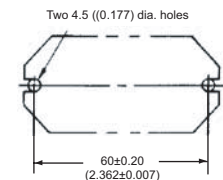

**Dimensions**

unit: mm (inch)

DLR10-2128; DLR10-2128-\*\*\*\*-K  
(E Bracket Attached)\*

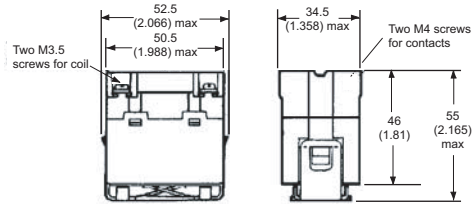

Terminal arrangement/  
Internal connections  
(Top view)

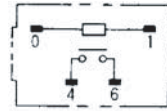

E Bracket  
Mounting holes  
(bottom view)

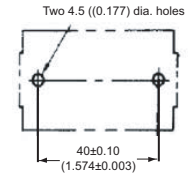

DLR10-2228; DLR10-2228-\*\*\*\*-K  
(E Bracket Attached)\*

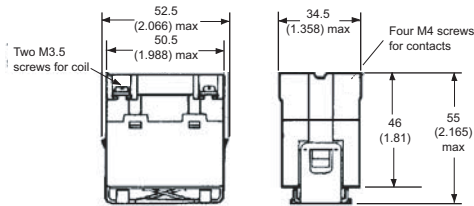

Terminal arrangement/  
Internal connections  
(Top view)

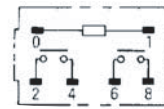

E Bracket  
Mounting holes  
(bottom view)

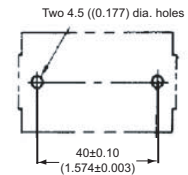

\* E Bracket must be ordered separately - see page 6 for details

DLR10-2148; DLR10-2148-\*\*\*\*-K

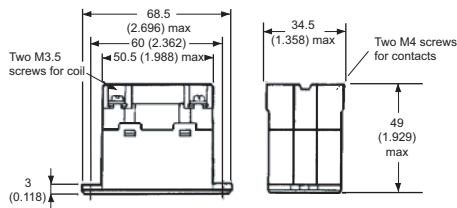

Terminal arrangement/  
Internal connections  
(Top view)

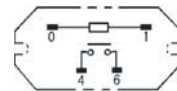

Mounting holes  
(Bottom view)

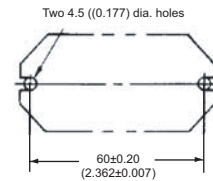

DLR10-2248; DLR10-2248-\*\*\*\*-K

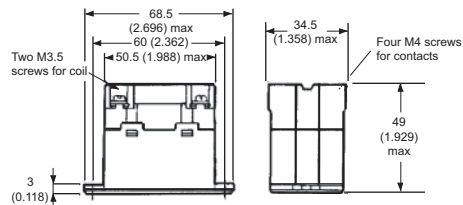

Terminal arrangement/  
Internal connections  
(Top view)

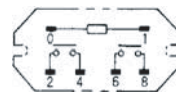

Mounting holes  
(Bottom view)

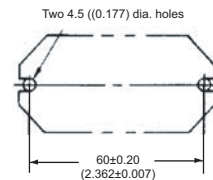

Dimensions

unit: mm (inch)

DLR10-2125

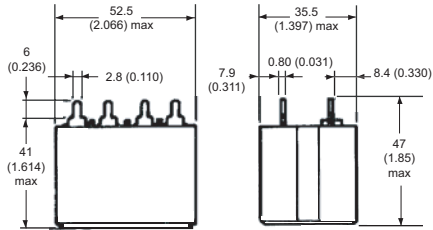

Terminal arrangement/  
Internal connections  
(Top view)

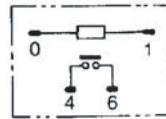

Mounting holes  
(bottom view)

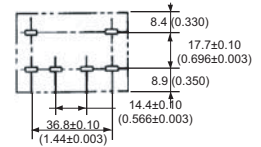

DLR10-2225

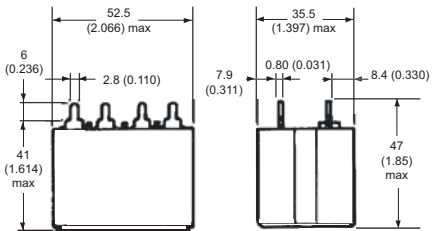

Terminal arrangement/  
Internal connections  
(Top view)

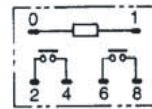

Mounting holes  
(bottom view)

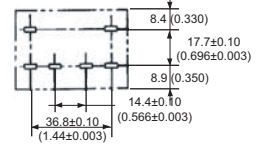

E bracket  
DLR99

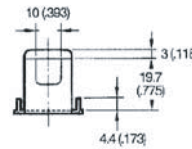
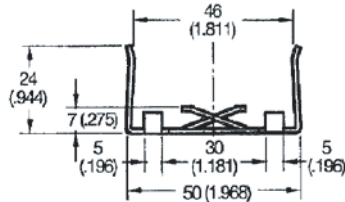
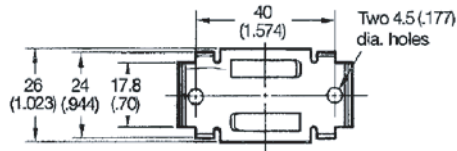

Mounting holes  
(Bottom view)

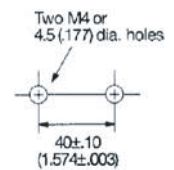

Dimensions

unit: mm (inch)

DIN Rail Adaptor  
DLR7LF-D

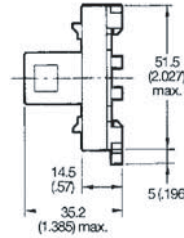
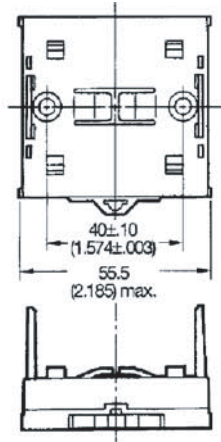
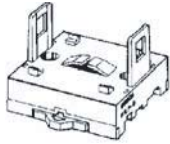

Mounting holes  
(Bottom view)

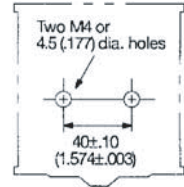

DIN Rail Front connecting socket  
DLR7LF-06

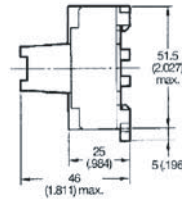
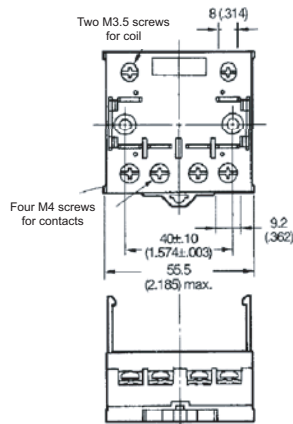
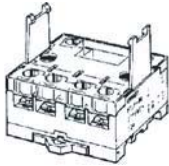

Mounting holes  
(Bottom view)

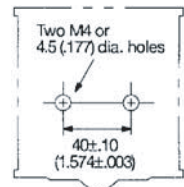

- Note: 1. To protect against electric shock, use the DLR7LF-C cover on terminals.  
2. DLR7LF-C cover is supplied with DLR7LF-06 socket