

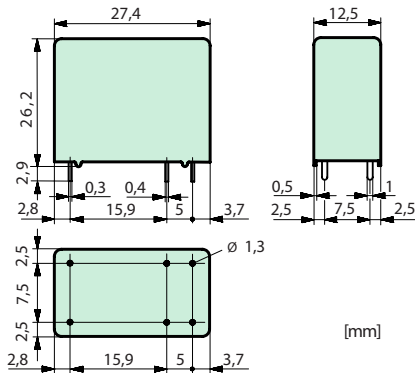

Relay Key Data

- PCB Relay with forcibly guided Contacts
- Protective separation between Coil and Contacts (Air and Creepage Distance >14mm); Protective separation between left and right Contact Side (Air and Creepage Distance >5.5mm)
- EN50205 Type A
- Contact Mounting: SIM112 1NO / 1NC
- Small external Dimensions
- Mean Coil Power 0.5W
- Holding Power 0.15W

Dimensions



Contact Data

Contact Material	AgSnO ₂ +0.2µm Au
Type of Contact	Crest Contact
Rated Switching Capacity	250VAC 8A AC1 2'000VA
Electr. life AC1(360 cycles/h)	ca. 100'000
Inrush Current max.	20A for 20ms
Switching Voltage Range	5 to 250 VDC/VAC
Switching Current Range*	10mA to 8A
Switching Capacity Range*	60mW to 2'000W(VA)
Contact resistance (as delivered)	≤100mΩ/6V/100mA

*Guided Values

Standard Coils for direct current (other voltages on request)

Nominal Voltage VDC	Min. Pick-Up Voltage at 20°C	Drop-Out Voltage at 20 °C	Nominal Current in mA	Resistance in Ohm at 20 °C
5	3.5	≥0.5	111.0	45 ± 10%
6	4.2	≥0.6	85.7	70 ± 10%
12	8.4	≥1.2	44.4	270 ± 10%
21	14.7	≥2.1	23.8	880 ± 10%
24	16.8	≥2.4	21.8	1'100 ± 10%
48	33.6	≥4.8	10.9	4'400 ± 13%
60	42.0	≥6.0	8.7	6'850 ± 15%
110	77.0	≥11.0	5.5	20'000 ± 15%

Circuit Diagram (Topview)

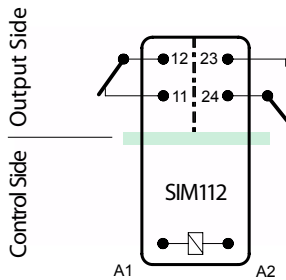

Insulation Data

- Double or Reinforced Insulation at 250VAC
- Air and Creepage Distance >5.5mm
- Test Voltage 4'000V/50Hz/1min
- Double or Reinforced Insulation at 250VAC
- Air and Creepage Distance >14mm
- Test Voltage 5'000V/50Hz/1min

Test Voltage contacts open	1'500V/50Hz/1min
Creepage Resistance	CTI 250
Pollution Degree	2
Overtoltage Category	III
Insulation Resistance at Up 500VDC	>100 MΩ

Additional Relay Data

Mechanical life	>10x10 ⁶ operations
Switching frequency, mechanical	15Hz
Response Time (all NO closed)	typ. 10ms
Drop-Out Time** (all NC closed)	typ. 3ms
Bounce Time of NO Contact	typ. 6ms
Bounce Time of NC Contact	typ. 12ms
Shock Resistance	16ms NO > 10g NC > 2.5g
Vibration Resistance (10-200Hz)	NO > 10g NC > 1g
Resistance to short circuiting output contacts	1'000A SCPD 10A qG/qL (pre-fuse)
Ambient Temperature	-40°C to +70°C
Thermal Resistance	55 K/W
Temperature Limit for Coil	120°C
Weight	approx. 20g
Mounting Position	any
Type of Protection	RT II
Solder bath Temperature	270°C/5s

**without spark suppression

Tests, Regulations

Approvals



UL File E188953	Sec. 3
Insulation class (IEC 60664-1)	250VAC
Protection class II	VDE 0106
Fire Protection requirements	UL 94 / V0

Optionen, Accessories

None

Product Key

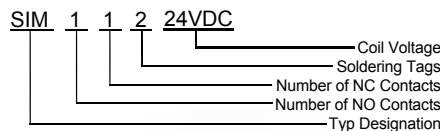

Contact Lifetime

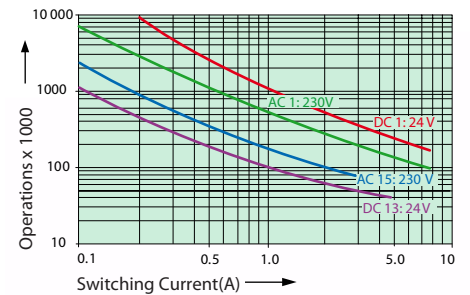

Max. Switching Characteristics (DIN EN60947-5-1, Tab.C2):

AC1:	250V / 8A
AC 15:	230V / 3A
DC1:	24V / 8A
DC 13:	24V / 6A / 0.1Hz
UL 508:	C150 / R300

Load Limit Curve Direct Current

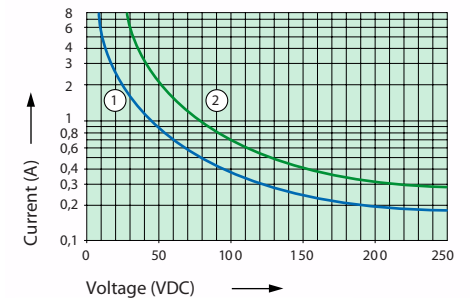

- 1) Inductive Load L/R 40ms
- 2) Resistive Load

Excitation Voltage Range

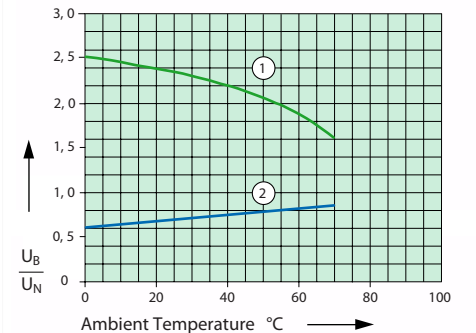

- 1) Max. excitation Voltage with Contact Load: <6A
- 2) Min. excitation Voltage (guaranteed Values) without previous operation.

No heat accumulation due to intrinsic heating of other components. Continuous Duty 100%.