

## Features

- > Adjustable switching point
- > Replaces various competitors types
- > Mains voltage variants available
- > Various sensitivity ranges available
- > Customized types available



		MS-313-3	MS-324-3	MS-324-4	MS-324-5	MS-324-7
Contact form		A	A	C	A	B
Contact rating max.	W/VA	10	10	5	10	5
Switching current max.	A	0.5	1	0.25	0.3	0.25
Switching voltage max.	VDC	150	200	175	200	175
	VAC	120	140	120	260	120
Pull in range available	AT	10-20	10-25	15-30	15-30	15-30
Operating Temperature	°C	-20 to +85	-20 to +85	-20 to +85	-20 to +85	-20 to +85
UL / CSA / RoHS		--/--/•	•/•/•	•/--/•	•/•/•	•/•/•

Matching actuators on page 32/33.

	MS-313-3	MS-324
Housing material	ABS	ABS
Cable type	AWG 26	AWG 24 (MS-324-4: AWG 26)

## Standard types

## Cable exit: right

### MS-313-3

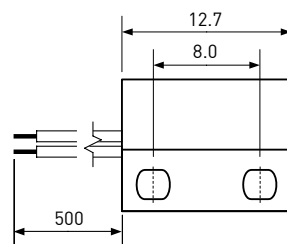
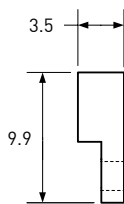

### MS-313R

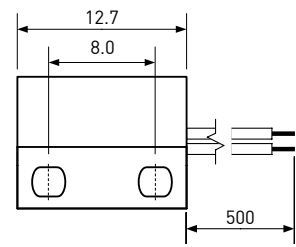

### MS-324

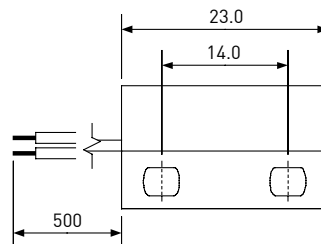
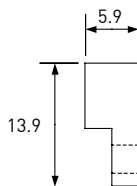

### MS-324R

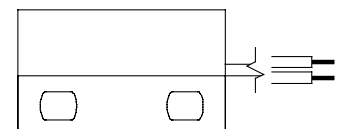

AT ranges and characteristics stated for unmodified Reed Switches.  
Pls. refer page 36/37 for additional technical information. All dimensions in mm. Subject to change without prior notice.



		MS-328-3 MS-332-3	MS-328-4	MS-328-5 MS-332-5	MS-328-6 MS-332-6	MS-328-7 MS-332-7
Contact form		A	C	A	A	B
Contact rating max.	W / VA	10	5	10	50	5
Switching current max.	A	1	0.25	0.3	1.5	0.25
Switching voltage max.	VDC	200	175	200	200	175
	VAC	140	120	260	250	120
Pull in range available	AT	10-25	15-30	15-30	25-40	15-30
Operating Temperature	°C	-20 to +85	-20 to +85	-20 to +85	-20 to +85	-20 to +85
UL / CSA / RoHS		•/•/•	•/•/•	•/•/•	•/•/•	•/•/•

	MS-328	MS-332
Housing material	PA66-GF	ABS
Cable type	AWG 20	AWG 24
	[MS-328-4: AWG 22]	

Matching actuators on page 32/33.

### Standard types

Cable exit: right

#### MS-328

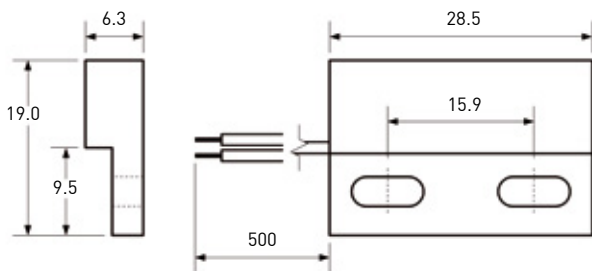

#### MS-332

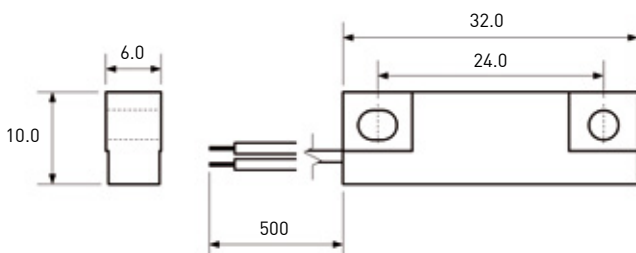

#### MS-332R

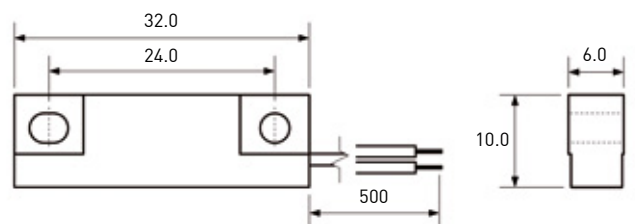

AT ranges and characteristics stated for unmodified Reed Switches.  
Pls. refer page 36/37 for additional technical information. All dimensions in mm. Subject to change without prior notice.