

EM series

Enhanced membrane keypads



ERMEC,SL
NIF: B-61068151



DISTINCTIVE FEATURES

- Membrane keypad with housing
- Surface mount
- Up to 3 keys
- Sealed up to IP67 and IP69K
- Custom graphic overlay on request



ENVIRONMENTAL SPECIFICATIONS

- Sealing : IP65 and IP67 according to IEC 60529
IP69K according to DIN 40050-9
- Operating temperature: -25 °C to +70 °C (-13 °F to +158 °F)
- Storage temperature : -40 °C to +70 °C (-40 °F to +158 °F)
- Impact resistance : IK10 according to EN 50102
- Flame resistance : UL HB
- Salt Spray : 96 hours according to IEC 512-6, test 11f
- Washable : most commonly used detergents and solvents



ELECTRICAL SPECIFICATIONS

- Electrical function: NO contacts
- Max. current/voltage rating with resistive load : 32 VDC, 30 mA
- Initial contact resistance ON : 10 ± 2 ohms
- Insulation resistance : 1 Gohm min. at 250 VDC



GENERAL SPECIFICATIONS

- Operating force : $2.6 \text{ N} \pm 25\%$
- Travel : $> 0.5 \text{ mm}$
- Mechanical life : 300,000 cycles
- Connection : $1,000 \text{ mm} \pm 20 \text{ mm}$ cable output with Deutsch connector DTM04-4P (supplied not assembled)
- Fixation : 4 inserts

The company reserves the right to change specifications without notice.



EM series

Enhanced membrane keypads



MATERIALS

- Overlay : polyester
- Housing : ABS
- Cable : PVC

APEM products may be recycled at end-of-life for the re-claiming of valuable metal components.



EXTRA FEATURES AVAILABLE ON REQUEST

- Custom cable (length and connector to be defined by customer)
- Custom overlay



CONNECTIONS

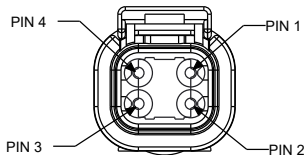

Connector Deutsch DTM04-4P
Supplied separately.

PIN	FUNCTIONS	COLORS
1	SW1	White
2	SW2	Yellow
3	SW3	Green
4	Common	Brown



MOUNTING CUT-OUT

STRAIGHT OUTPUT

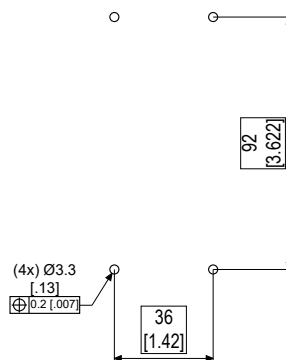

90° OUTPUT

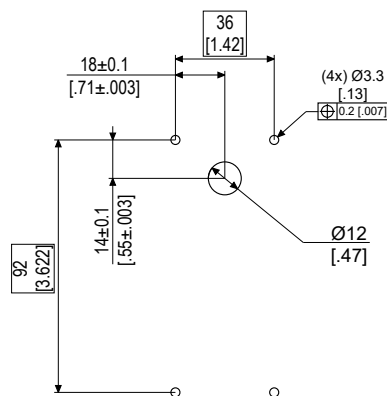

EM series

Enhanced membrane keypads



BUILD YOUR PART NUMBER

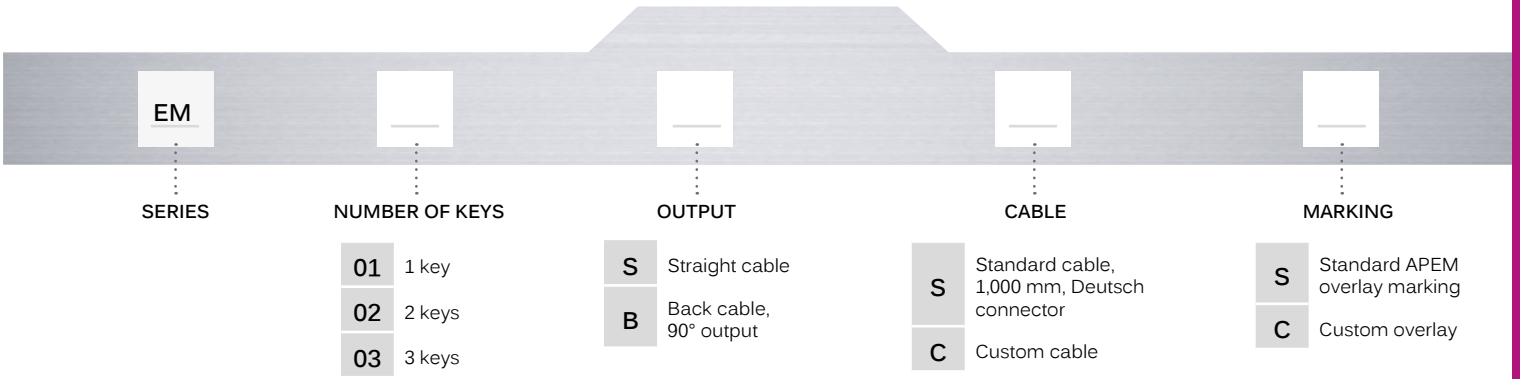

ERMEC, S.L. BARCELONA
C/ Francesc Teixidó, 22
08918 Badalona
(España)
Tel.:93.450.16.00



Tel.: (+34) 902 450 160
Fax: (+34) 902 433 088
info@ermec.com
www.ermec.com

ERMEC, S.L. MADRID
c/Puerto Rico, 4
28220 Majadahonda
(España)
Tel.:91.828.56.51

PORTUGAL
portugal@ermec.com
BILBAO
bilbao@ermec.com

EM series

Enhanced membrane keypads

3 KEY MODEL WITH STRAIGHT OUTPUT



EM03SSS

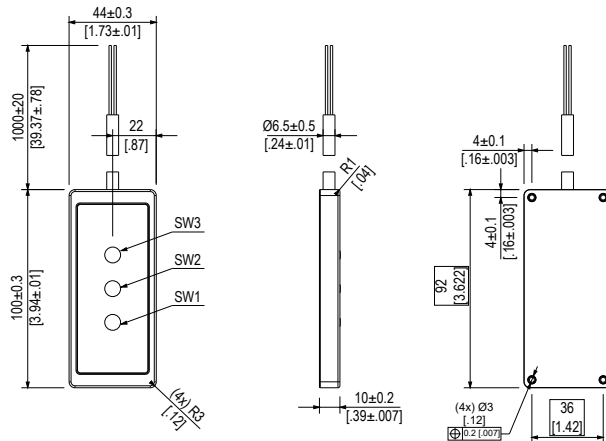

3 KEY MODEL WITH 90° OUTPUT



EM03BSS

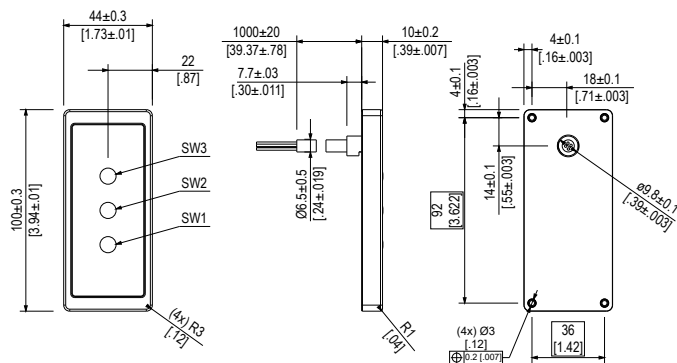

OVERLAY CUSTOMIZATION

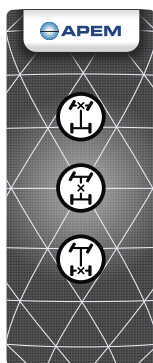

Standard APEM marking

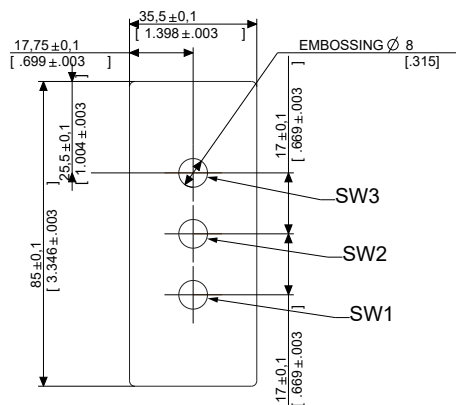

Custom overlay

Template for custom overlay creation (AI or EPS format) available on request.