

Board-on SMT IDC Cable Connectors

SMC Series

Economical board-to-wire solution in pitch 1.27 mm

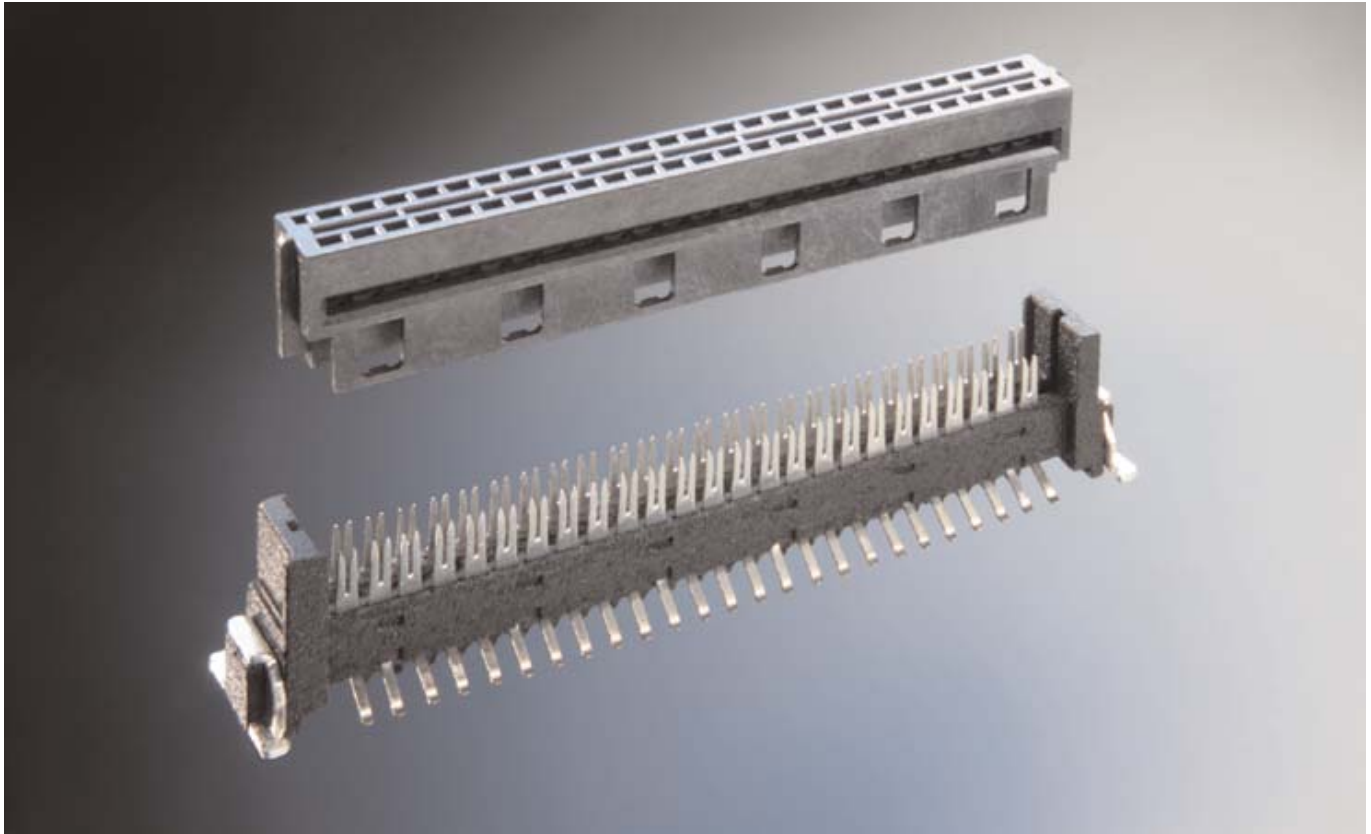

General

This new SMC connector implements the connection between a flat cable and the printed circuit board by means of just one connector. The flat cable is harnessed quickly by means of specially developed application tools. The connectors have been developed for fully automatic SMT assembly and are characterized by the following features:

Black insulation body for easy visual recognition and high temperature resistant thermoplastics for all standard SMT reflow soldering processes. The connectors are fitted with a pre-populated assembly hood for safe gripping with the vacuum pipette and have been designed for the fully automatic feed by means of the tape and reel packaging.

The assembly process subdivides into 3 phases:

- Connector is fitted fully automatically to SMT assembly and soldered in by means of the SMT reflow soldering process.
- Flat cable is pre-configured and made up in cable guide.
- Made-up cable guide assembly is placed on connector and, using an application tool, cable make-up will be completed.

Technical Data

- Number of Pins: 12, 26 and 50
- Pitch: 1.27 mm
- Termination
PCB: SMT
Flat Cable: IDC
- Dielectric Strength
contact - contact: 500 V
- Materials
Housing: LCP
Contact: Cu alloy
- Plating
Termination area: Sn

Ordering Information

| Configuration | Pin-No. | Packaging | Quantity | Part-No. |
|---------------|---------|---------------|----------|----------|
| Connector | 12 | Tape and Reel | 280 pcs. | 134418 |
| Connector | 26 | Tape and Reel | 280 pcs. | 134419 |
| Connector | 50 | Tape and Reel | 280 pcs. | 134420 |
| Cable guide | 12 | Poly bag | 280 pcs. | 134423 |
| Cable guide | 26 | Poly bag | 280 pcs. | 134424 |
| Cable guide | 50 | Poly bag | 280 pcs. | 134425 |

PCB-Layouts Frontside

12 pin

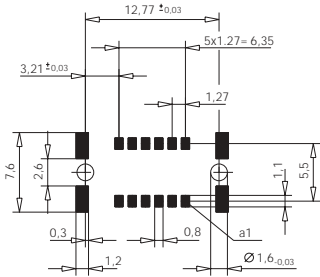

26 pin

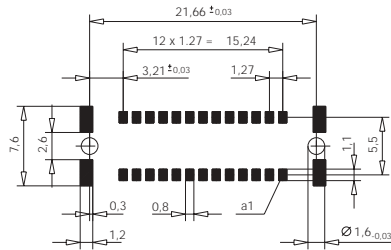

50 pin

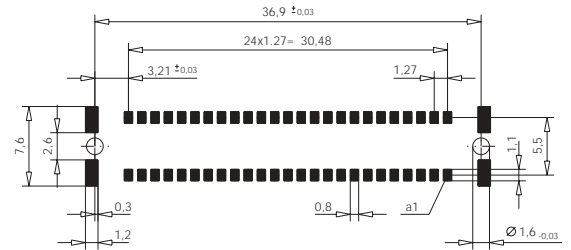

PCB-Layouts Rearside

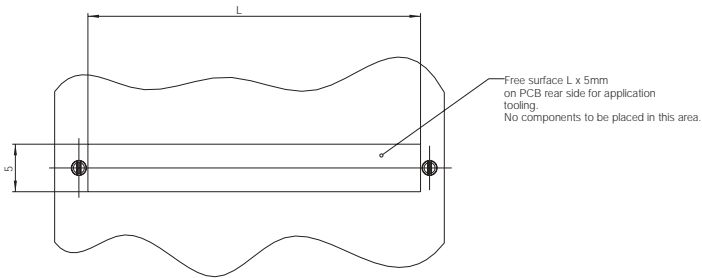

| | 12 pin | 26 pin | 50 pin |
|---|--------|--------|--------|
| L | 11 | 20 | 35.0 |

Dimensions (50 pin Version)

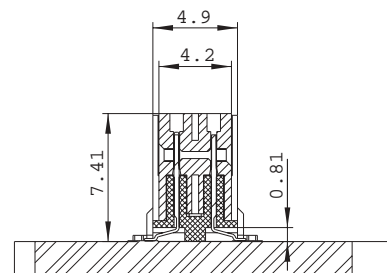
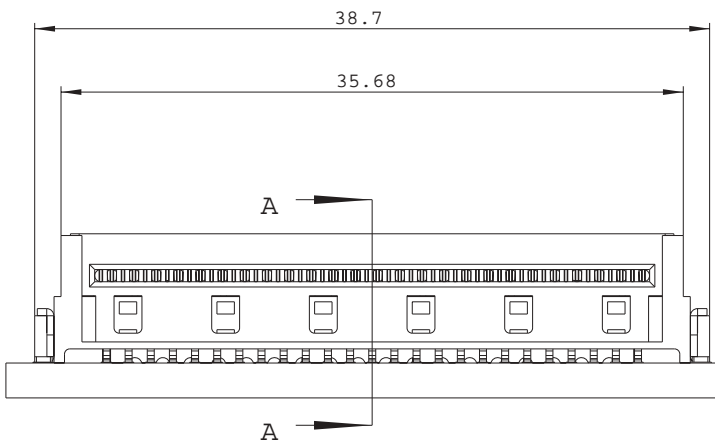

A-A

